

8 7 6 5 4 3 2 1

E
D
C
B
A

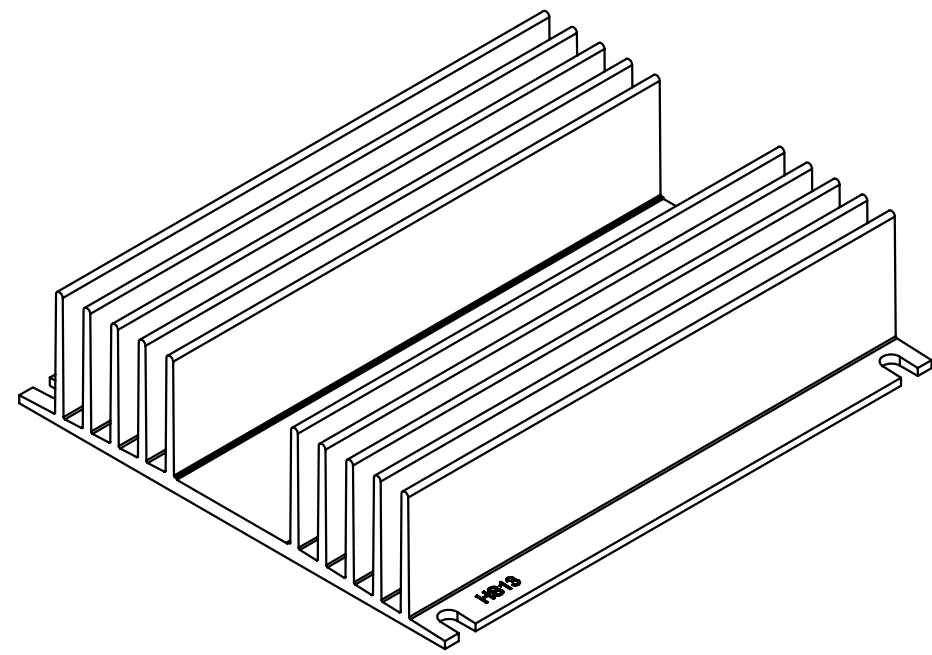

P1 HEATSINK
 MAT'L: 6063-T5 ALUMINUM (AAVID EXTRUSION #60840)
 FINISH: ANODIZE PER MIL-A-8625, TYPE II, CL 2, BLACK
 TYPICAL BREAKDOWN VOLTAGE > 300V

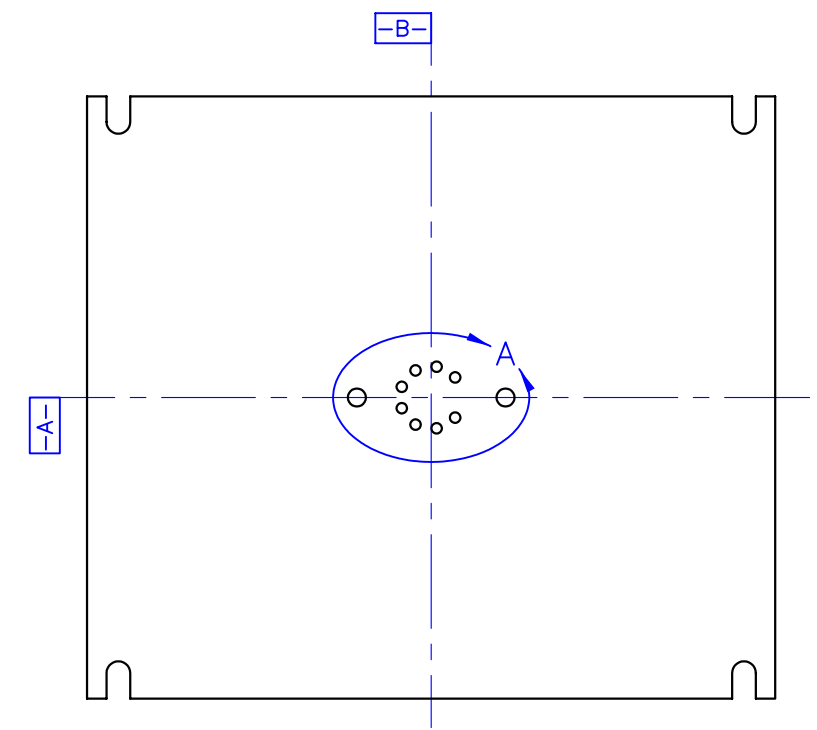
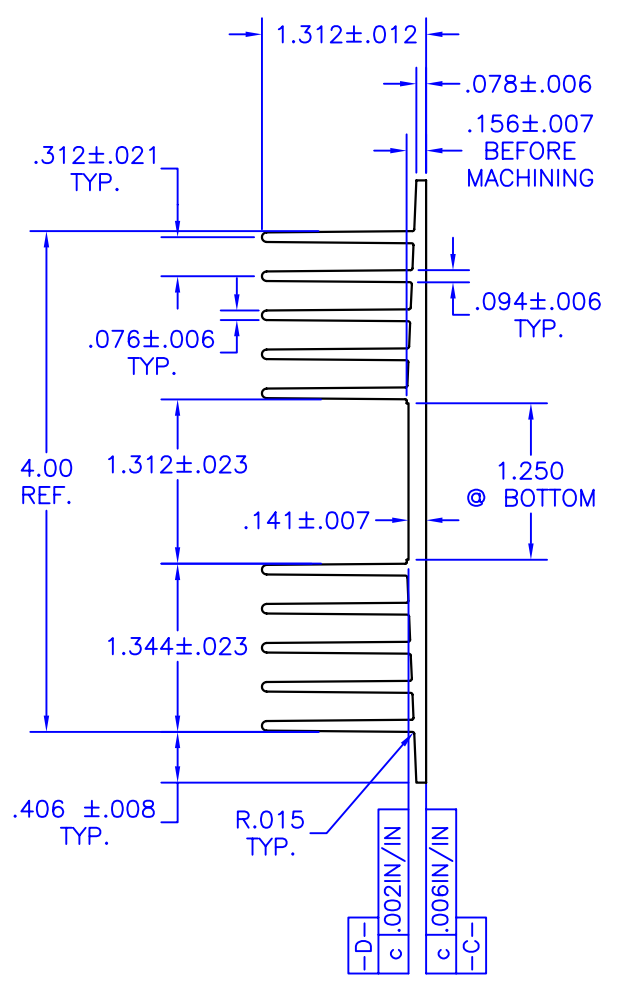
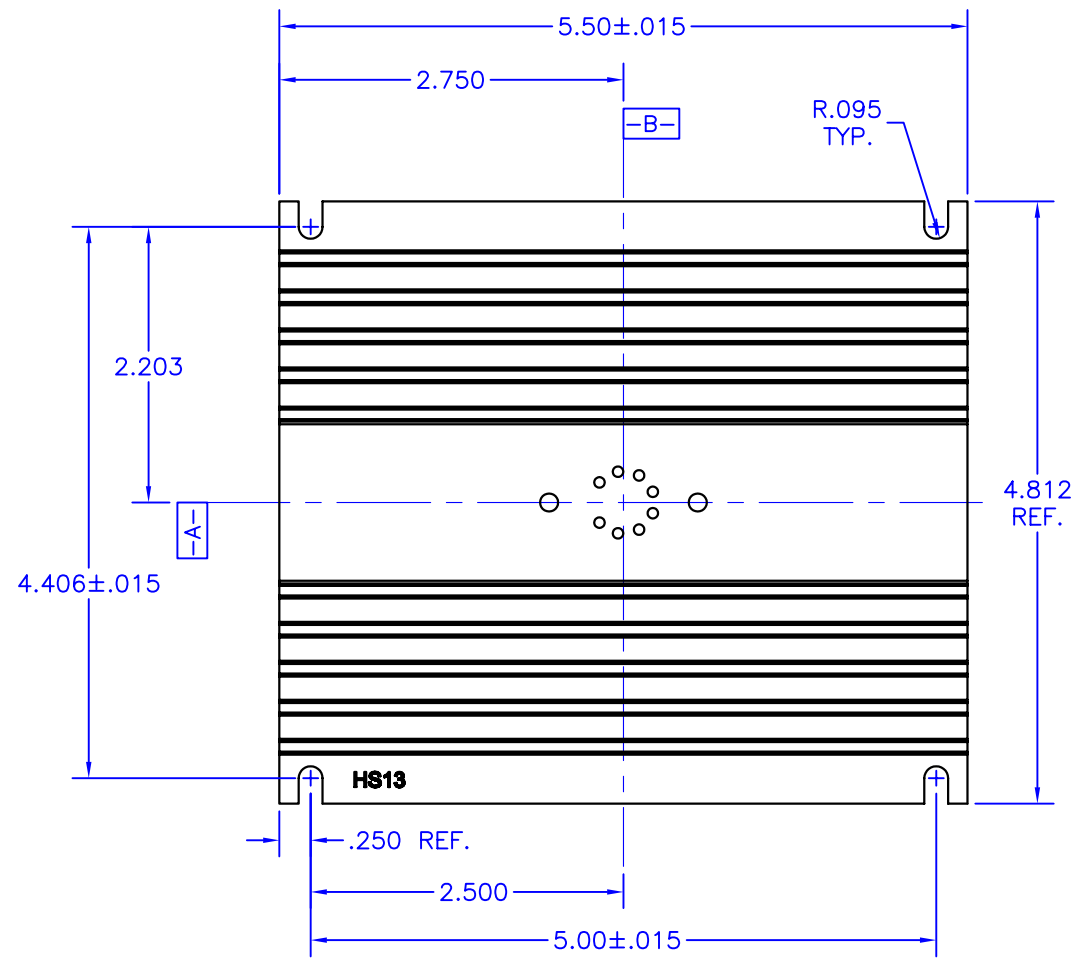
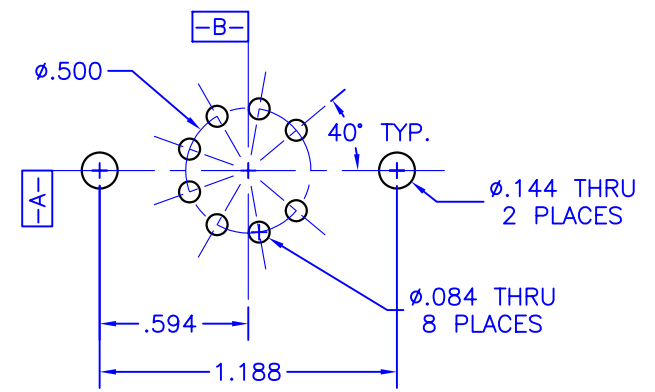

DETAIL A
SCALE: 2X

NOTES:

1. UNLESS OTHERWISE NOTED, ALL DIMENSIONS ARE IN INCHES.
2. BREAK ALL SHARP EDGES, DE-BURR & REMOVE LOOSE CHIPS.
3. MARK WITH CONTRASTING INK AS SHOWN, IF SPECIFIED BY PURCHASE ORDER.

TOLERANCES - UNLESS OTHERWISE SPECIFIED .XX = ±.01 .XXX = ±.005 ANG. = ±.5°			TITLE TO3 PACKAGE HEATSINK		MODEL HS13
SUBJECT MECHANICAL DRAWING			DATE D-M	TECH/ENGR D-M	DOA 43521
		SHEET 1 OF 1		FILENAME HS13-G	DATE 04/14/04

8 7 6 5 4 3 2 1